



The Tirfor is a highly versatile device. Its ergonomic design and lightweight make easy to transport, install and handle. It can be used in various configurations and situations, enabling work with long rope lengths. The Tirfor can pull, lift, and position loads with millimetre precision. Its capacity can be multiplied using a pulley block (*). The TU range is known for its unrivalled robustness, meeting the requirements of the EN13157 standard in the workplace.

* Information about our Tirfor TU range is available on request from Tractel or on www.tractel.com

APPLICATIONS

- Construction
- Mining industry
- Quarry
- Rescue
- Ski lift
- Forester
- Others

TECHNICAL CHARACTERISTICS

- Possibility of multiplying its rated capacity by means of sheaving pulley(s)
- Load limiter (two sets of additional safety pins supplied with the product)
- Equipped with a QR code for product traceability and technical monitoring
- To use the Tirfor, you need 3 components:



1. Tirfor TU
2. Telescopic operating handle
3. Wire rope by Tractel on reeler

- Tirfor

TU8		Weight: 8.4 kg		TU16		Weight: 18 kg		TU32		Weight: 27 kg							
W.L.L.	Effort to control lever (kg)		Wire rope travel (mm)		Dimension (mm)												
	daN	Forward	Reverse	Forward	Reverse	A	B	C	D	E	F	G	H	I	J	K	L
TU8	800	43	21	70	76	265	32	30	40	527	397	70	194.5	58	28	285	108
TU16	1600	54	20	56	70	330	38	30	48	660	483	85.5	236	80	31	360	140
TU32	3200	54	25	30	48	28	28	620	93	328	256	50	156	330	680	1150	-

Serial anchoring hook on Tirfor TU and TU16, and anchoring pin on Tirfor TU32 (optional: anchoring hook)

- Telescopic operating handle

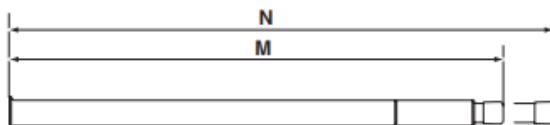

	Dimension (mm)		Weight (kg)
	M	N	
TU8	395	620	1
TU16	680	1190	2.4
TU32	680	1190	2.4

- Wire rope

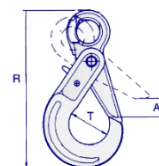

	Ø (mm)	Breaking load of wire rope (daN)	Weight per meter (kg)	Dimensions of hook (mm)			
				A	R	T	Weight (kg)
TU8	8.3	4000	0.25	28	141	35	0.51
TU16	11.5	8000	0.5	34	173	43	0.94
TU32	16.3	16000	1	45	214	56	1.62

OPTIONS

- Anchoring hook

Hook CT3 : 021877

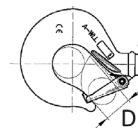
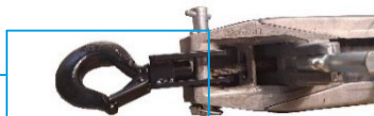

D = 35 mm

- Sheave block

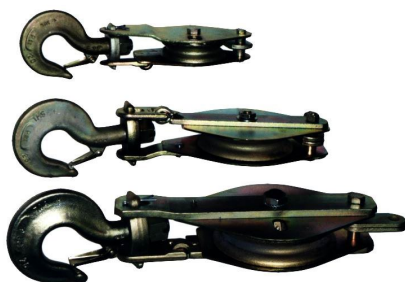

	TU8	TU16	TU32
Reference	E460H	E470H	E480H
EN13157 compliance			-
W.L.L. (t)	2.4	4.8	6.4
Ø wire rope : mini/ maxi (mm)	7.5 / 8.3	10 / 11.5	14 / 16.3

Information about our sheave blocks range can be obtained upon request to Tractel or on www.tractel.com.

APPLICABLES STANDARDS

- EN13157
- European directive 2006/42/EC
- UKCA Regulation:

Complies with all relevant provisions of the 2008 Supply of Machinery (Safety) Regulations (SI 2008/1597) as amended (SI 2011/1042, SI 2011/2157, SI 2019/696)

PRODUCT CODE AND LOGISTIC INFORMATION

Code	Description	Code EAN	Weight Net (kg)	Weight (incl. packaging) (kg)	Dimensions packaging
18009	TU8	3600230180090	8.4	10	530x250x110
18029	TU16	3600230180298	18	20	650x310x140
18039	TU32	3600230180397	27	29	700x370x160